

Reducer

Technical Information — Sizes

Reducer

Reducers are used to transition from laminate flooring to floors of different height.

Surface Material: High Wear Resistant Aluminum Oxide Laminate

Core Material: Moisture Resistant MDF

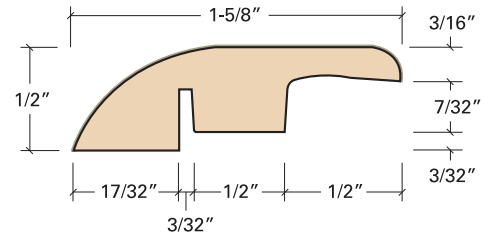

Versatrack Shim

To be used with T-Molding, Reducer and End Cap in conjunction with the Versatrack (metal) for floors from 9.5mm-12.3mm thickness including 3/32nd underlayment.

Material: Standard HDF

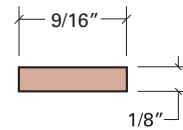

Versatrack

To be used with T-Molding, Reducer and End Cap for floors from 6mm-9.5mm thickness including 3/32nd underlayment. Also, used in conjunction with the Versatrack Shim for 9.5mm-12.3mm* including 3/32nd underlayment.

Material: Cold Roll Steel

* For floors thicker than 12.3mm, please feel free to call one of our sales representatives for assistance.

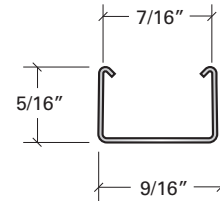

Installation

6 – 9 mm Floors

Use Versatrack (Metal Track) for 6 - 9.5 mm floors.

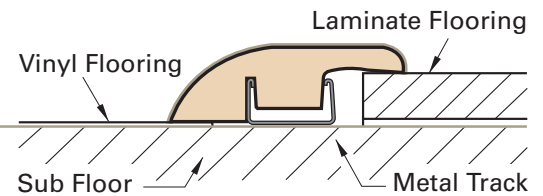

9.5 – 12.3 mm Floors

Use Versatrack & Versatrack Shim for 9.5 - 12.3 mm floors. Use the same molding & track, just add 1 Versatrack Shim.

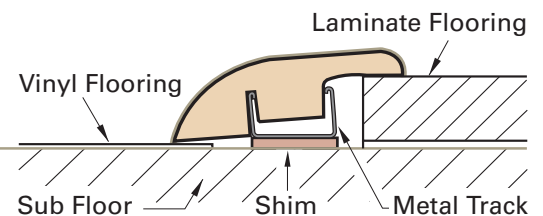

14 – 15 mm Floors

Use Versatrack & Versatrack Shim for 9.5 - 12.3 mm floors. Use the same molding & track, just add 2 Versatrack Shim.

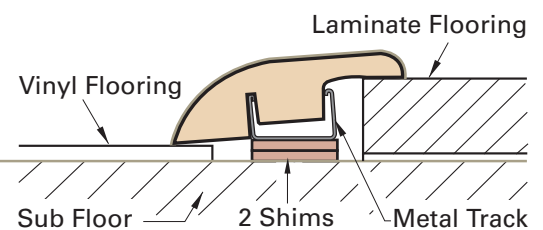

Reducer

Use Versatrack (Metal Track) for 6 - 9 mm floors.

6 - 9 mm Floors

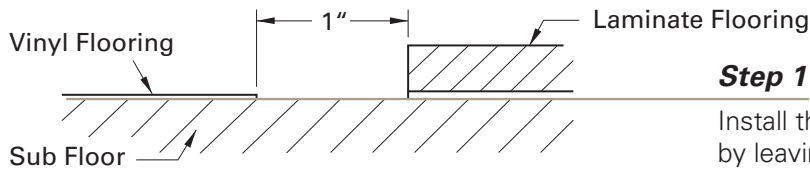

Step 1

Install the flooring planks including the underlayment by leaving a 1" inch (25mm) gap between the vinyl and the laminate floor for the installation of the Reducer.

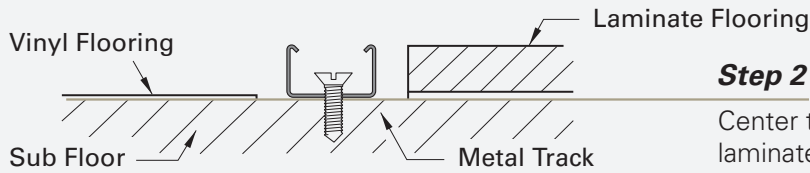

Step 2

Center the U-Track between the vinyl and laminate floor and screw it to the sub-floor by using 4x3/4" screws.

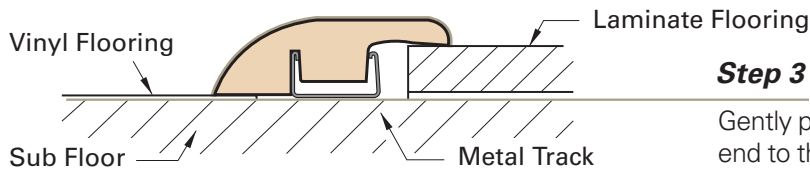

Step 3

Gently press the molding into the track starting from one end to the other just like you would close a Zip-Lock bag.

!!! Do not try to push the entire molding in all at once by just pressing it in from top !!!

Use Versatrack & Versatrack Shim for 9.5 - 12.3 mm floors. Use the same molding & track, just add Versatrack Shim.

9.5 - 12.3 mm Floors

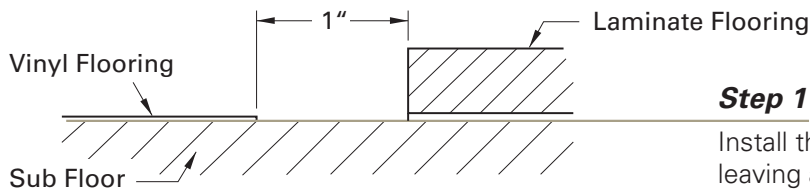
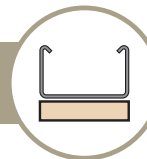

Step 1

Install the flooring planks including the underlayment by leaving a 1" inch (25mm) gap between the vinyl and the laminate floor for the installation of the Reducer.

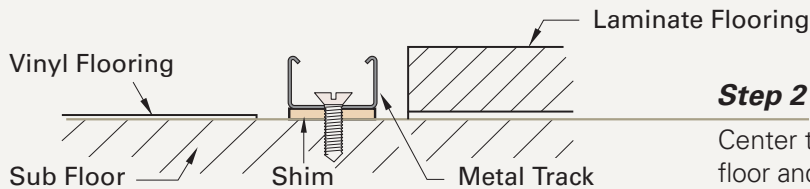

Step 2

Center the U-Track and Shim between the vinyl and laminate floor and screw them to the sub-floor by using 4x5/8" screws.

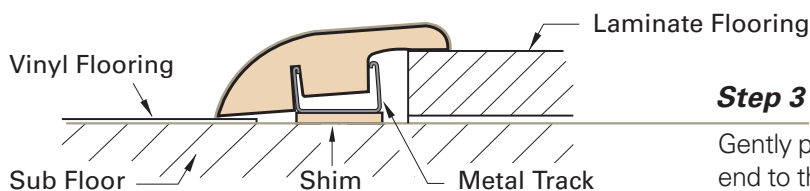

Step 3

Gently press the molding into the track starting from one end to the other just like you would close a Zip-Lock bag.

!!! Do not try to push the entire molding in all at once by just pressing it in from top !!!

Reducer

Use Versatrack & Versatrack Shim for 14 - 15 mm floors.
Use the same molding & track, just add Versatrack Shim.

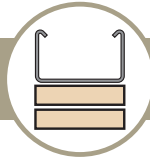

14 - 15 mm Floors

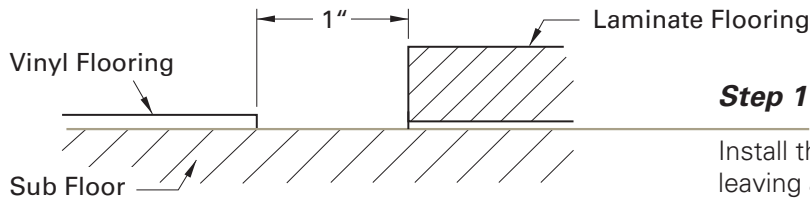

Step 1

Install the flooring planks including the underlayment by leaving a 1" inch (25mm) gap between the vinyl and the laminate floor for the installation of the Reducer.

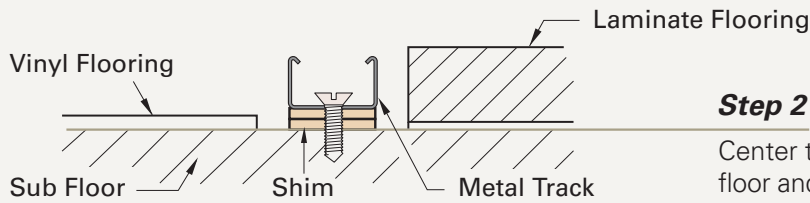

Step 2

Center the U-Track and Shim between the vinyl and laminate floor and screw them to the sub-floor by using 4x5/8" screws.

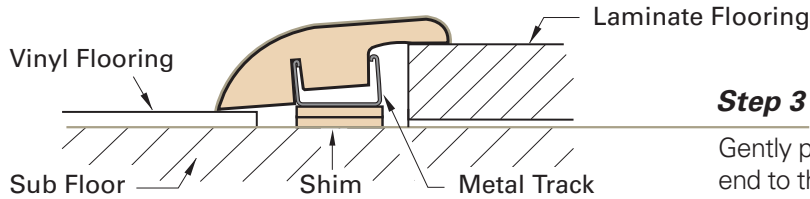

Step 3

Gently press the molding into the track starting from one end to the other just like you would close a Zip-Lock bag.
!!! Do not try to push the entire molding in all at once by just pressing it in from top !!!