

SONO is a premium ceramin-based composite. As such it has hybrid properties of Ceramic tile, LVT, and laminates. Installation and handling may vary from other products you may have installed. Please carefully read the points below; and if you have any questions, consult our installation manual, contact your specialty floor covering retailers, or call our support line at 888.255.3412.

GENERAL INFORMATION

- For indoor use only.
- Inspect cartons for visible damage. Cartons must always be placed flat. DO NOT stand carton on its end.
- Inspect all planks prior to installation for visible defects.
- Ensure that sub floor is structurally sound and clean.
- Sub floor variations should not exceed 3/16 inch in 10 feet.
- Concrete moisture content should not exceed 8.0 lbs/1000 ft² per 24 hours ASTM F1869. Failure to do so can result in mold conditions underneath the vapor barrier.
- SONO should not be installed in areas where temperature extremes will be below -40 degrees Fahrenheit or greater than 150 degrees Fahrenheit (-40° C to 65° C).
- Acclimation is not required if the product and installation area are between 60 to 100 degrees Fahrenheit (15° C to 38° C).
- Installation should be completed in conditions above 60 degrees Fahrenheit (15° C).
- Maximum distance in either direction is 100 feet without transitions.
- Use an expansion space of 1/4inch to 3/8 inch.
- Dynamix Prime or equivalent underlay is required for floating installation. Other underlays must meet or exceed a minimum 14.25 psi crush and have a maximum 1.5 mm thickness. Over concrete, 6 mil polyethylene vapor barrier is required (commonly pre-attached to the underlay).
- NEVER USE TAPPING TOOLS ON SONO.
- Always mix 3 to 4 cartons for best overall color placement.
- SONO is a fold down/drop lock installation method. For best results when engaging the short end lock, press down on the lock from the inside seam (nearest the previous row) to the outside. A non-marking seam roller can be very helpful (Contact your dealer with any questions).

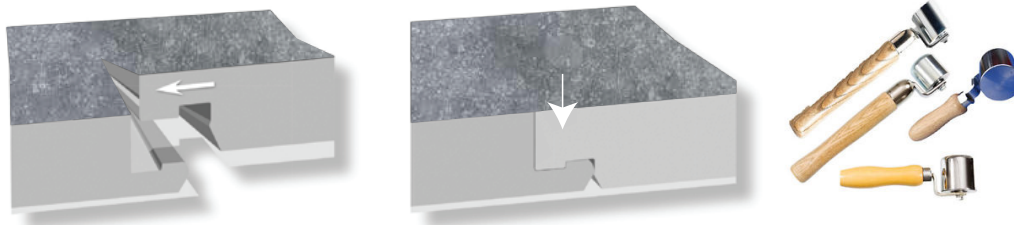

- Minimum board stagger is 16 inches from adjacent end joints.
- If required, when uninstalling SONO planks make sure to slide the planks apart. Strong vertical movement will break the retention clip and result in plank damage.

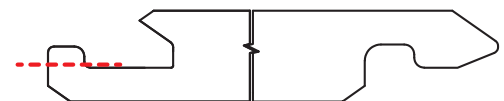
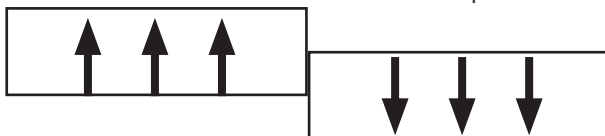

- When installing under door jambs or other locations that prevent angling for insertion. You will need to trim the vertical member of the groove and then use a premium adhesive to hold plank.
- Detailed installation manual, and glue down installation manual are available at www.inhaussurfaces.com.

SONO is a premium ceramin-based composite. As such it has hybrid properties of Ceramic tile, LVT, and laminates. Installation and handling may vary from other products you may have installed. Please carefully read the points below; and if you have any questions, consult our installation manual, contact your specialty floor covering retailers, or call our support line at 888.255.3412.

GENERAL INFORMATION

- For indoor use only.
- Inspect cartons for visible damage. Cartons must always be placed flat. DO NOT stand carton on its end.
- Inspect planks during installation for visible defects.
- Ensure that sub floor is structurally sound and clean.
- Sub floor variations should not exceed 3/16 inch in 10 feet.
- SONO can be installed using a variety of approved adhesives, please contact customer support for the full list. In the case of any conflict between SONO instructions and your adhesive instructions please contact customer support at 888.255.3412.
- Please follow instructions for your adhesive including; site conditions setting time, laying time, trowel, etc.
- The adhesive must be applied over the entire installation area.
- SONO should not be installed in areas where temperature extremes will be below -40 degrees Fahrenheit or greater than 150 degrees Fahrenheit (-40° C to 65° C). Note your adhesive range, this may have a different operating range which should be used.
- Acclimation is not required if the product and installation area are between 60 to 100 degrees Fahrenheit (15° C to 38° C).
- Installation should be completed in conditions above 60 degrees Fahrenheit (15° C).
- Maximum distance in either direction is 100 feet without transitions.
- Always mix 3 to 4 cartons for best overall color placement.
- NEVER USE TAPPING TOOLS ON SONO.
- SONO is a fold down/drop lock installation method. For best results when engaging the short end lock, press down on the lock from the inside seam (nearest the previous row) to the outside. A non-marking seam roller can be very helpful (Contact your dealer with any questions).

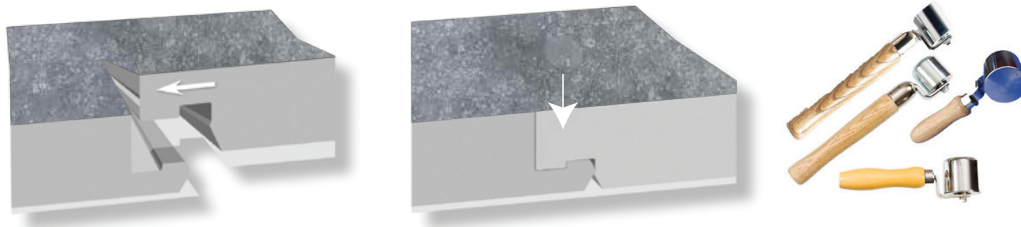

- Minimum board stagger is 16 inches from adjacent end joints.
- If required, when uninstalling SONO planks make sure to slide the planks apart. Strong vertical movement will break the retention clip and result in plank damage.

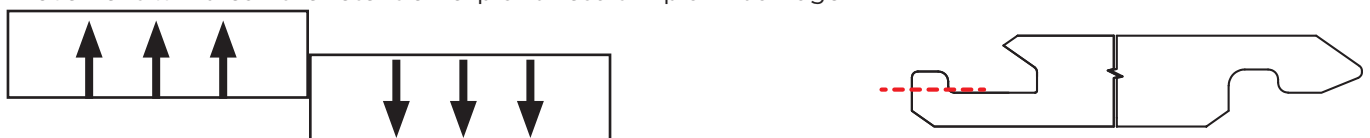

- When installing under door jambs or other locations that prevent angling for insertion. You will need to trim the vertical member of the groove and then use a premium adhesive to hold plank.
- Detailed installation manual, and glue down installation manual are available at www.inhaussurfaces.com.